

STANDARD FEATURES

EXTERIOR FINISHES

- Classic architectural detailing with brick water table
- Insulated, thermal break, maintenance-free vinyl single-hung windows
- Low maintenance steel raised panel overhead garage doors with windows
- Sodded front & side yards, seeded rear yard with landscape package
- Brick/Hardie-Plank exterior siding with 15 year warranty
- Vented crawl space foundation
- Spacious low-maintenance raised patio with railings
- Custom designed front porch rails & columns
- Sturdy OSB™ sheathing on all exterior walls
- Three exterior water spigots servicing front & rear yards
- Weatherproof exterior electrical outlets located front, rear & side

INTERIOR DETAILING

- 2-Car finished garage with front-load entrance & 8' tall garage door openings
- 9' Ceilings on first floor; vaulted ceiling in family room
- Quality upgraded wall-to-wall carpeting & pad
- Arch-top Continental™ style interior doors throughout
- Upgraded light fixture package
- Oak handrails & balcony rails (per plan)
- Upgraded Kwikset Ashfield™ lever hardware
- Direct vent gas fireplace with gas logs in family room including upgraded hearth & custom wood mantel
- Ceiling fan pre-wires in bedrooms, family room & loft
- Crown molding in foyer, dining room & kitchen
- Chair rail in dining room
- Custom profile wide 3-1/4" casing & 5-1/4" large bead baseboard moldings
- Plastered walls & ceilings
- Custom designed wood shelving systems in all closets
- Spacious walk-in closet in master bedroom suite
- Cable ready TV jacks & phone jacks in all bedrooms

ELEGANT BATHS

- Luxury master bath with separate shower, jetted tub & raised dual-bowl vanity
- Custom maple cabinetry
- Ceramic tile shower walls & ceiling in master bath*
- 12"x12" Ceramic tile flooring
- Cultured marble bath vanity tops
- Upgraded Delta® faucets with solid brass construction
- Exhaust fans in all bathrooms
- Elongated water-saver toilets in all bathrooms
- Temperature & pressure regulated shower & bathtub valves

MAGNIFICENT KITCHEN

- Solid granite kitchen counter surfaces
- Custom maple cabinetry with crown molding & 30" wall cabinets*
- Upgraded Delta™ kitchen faucet & sprayer
- Stainless steel undermount deep kitchen sink
- Built-in breakfast bar seats up to 4 family members
- Pantry (per plan)
- Custom refrigerator enclosure with ice-maker hook-up
- 12"x12" Ceramic tile or hardwood floors
- GE® Appliances – multi-cycle dishwasher, vented microwave oven, smooth-top electric range & garbage disposal*

COMFORT AND CONVENIENCE

- 2-Zone energy efficient Trane® natural gas/electric heating system with digital programmable thermostats
- 2-Zone Comfortable Trane® 13 SEER Central Air conditioning
- Energy efficient & quick recovery natural gas hot water heater
- Polysealed & caulked air infiltration barriers
- 200 Amp electric service with circuit breakers
- Garage door opener outlets
- Interconnected smoke detectors in all bedrooms with battery backup
- R-30 Ceiling insulation
- R-19 Crawl space floor insulation
- R-13 Exterior wall insulation
- Spacious floored storage areas with easy access

QUALITY CONSTRUCTION

- Tyvek® energy efficient house wrap
- Heavy-duty engineered floor joists – offering superior dimensional stability & uniformity; spaced at 16" on center
- ¾" Tongue & groove subfloor; glued & nailed
- All underground utilities
- Architectural roof shingles with 30 year warranty
- Ice & water shield protection for roof system
- Insulated steel raised panel front entry door with sidelights
- Ground fault electrical interrupter circuits in kitchen, master bath & all exterior receptacles
- One-year builder warranty on the entire home
- Ten-year HW-10 warranty on major structural components

*Per Plan

www.crestlinehomesva.com
757.499.7000

CRESTLINEHOMES



All information contained herein is based on the latest product information available at the time of printing. While Crestline Homes makes all reasonable efforts to provide accurate information, we also maintain the right to improve upon our designs at any time. As a result, there are no guarantees or warranties of prices, plans, specifications or materials represented in this brochure. Furthermore, we do not assume any liability for the accuracy or completeness of the illustrations and specifications presented. Illustrations are artists' interpretations only and are not meant to be an exact interpretation. This brochure shall not be relied upon as a substitute for current information available from your authorized Crestline Homes representative.

SITE MAP

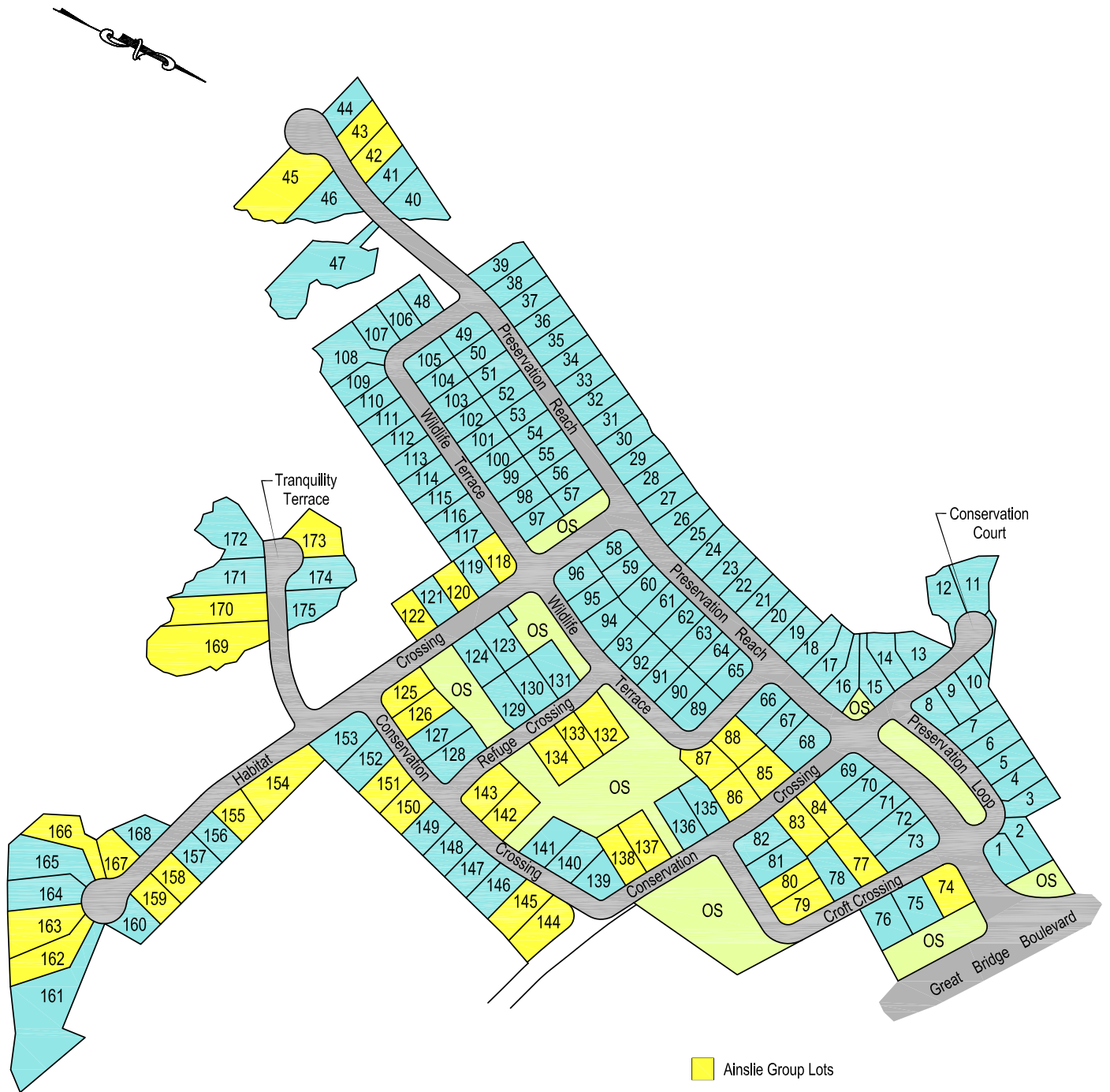

www.crestlinehomesva.com
757.499.7000

CRESTLINEHOMES



All information contained herein is based on the latest product information available at the time of printing. While Crestline Homes makes all reasonable efforts to provide accurate information, we also maintain the right to improve upon our designs at any time. As a result, there are no guarantees or warranties of prices, plans, specifications or materials represented in this brochure. Furthermore, we do not assume any liability for the accuracy or completeness of the illustrations and specifications presented. Illustrations are artists' interpretations only and are not meant to be an exact interpretation. This brochure shall not be relied upon as a substitute for current information available from your authorized Crestline Homes representative.